

GO UP IN THE WORLD!

Ancar

DENTAL
INTELLIGENCE
with heart

Since 1958

IN INNOVATION
IN DESIGN
IN EXPECTATIONS

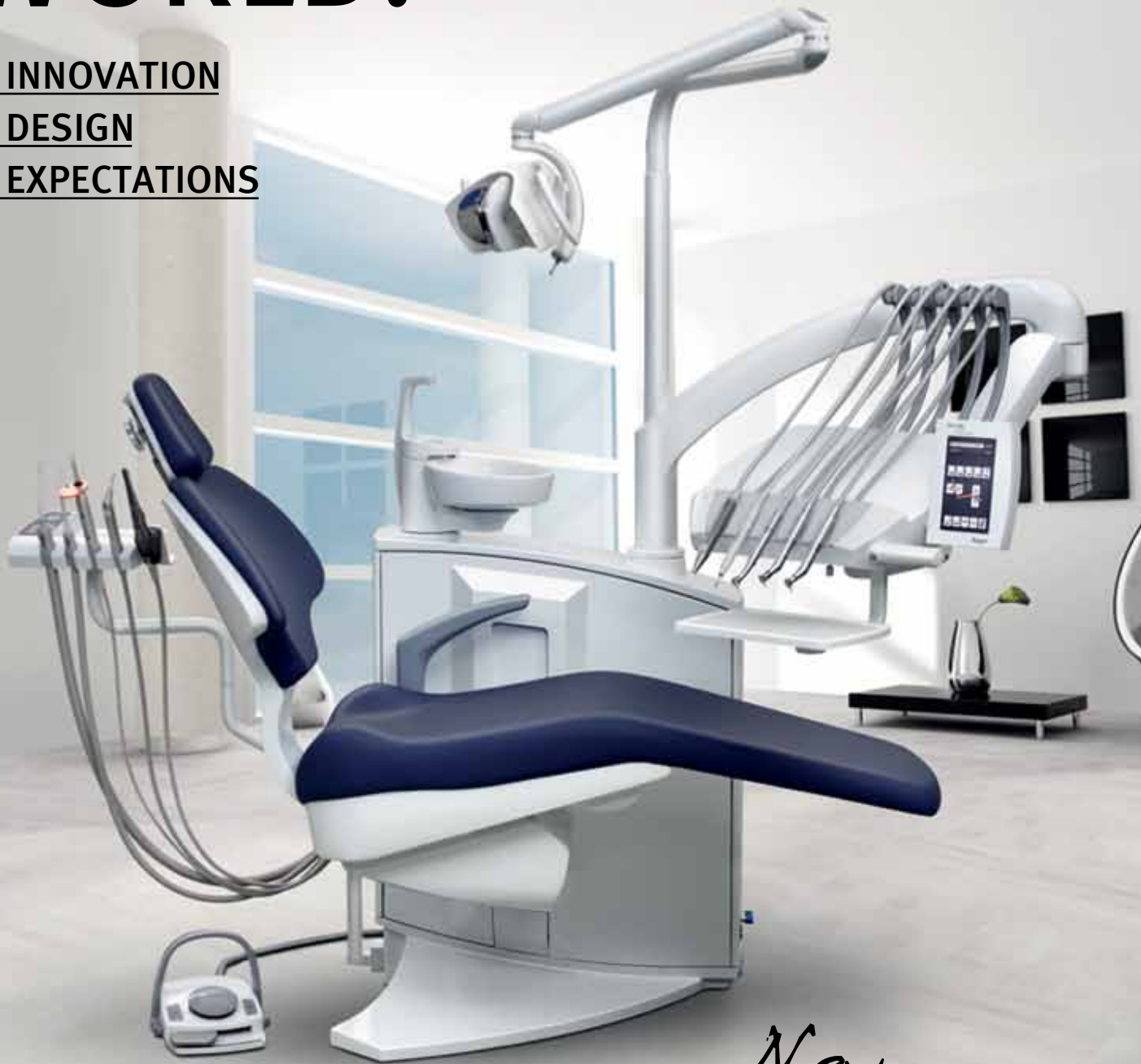

*New
Series 5*

Series 5 of treatment centres, chairs and mobile delivery carts made in aluminium 

Sd-550 / Sd-575 / Sd-580 *Touch Expert*



WELCOME TO THE WORLD OF ANCAR

Welcome to the **New Series 5**: treatment units with suspended chair and vertical elevation. Open space under the chair, without obstacles, allowing greater leg-room for dentists and their assistants.

Its ergonomic design means all the components are integrated and coordinated together, so that any dental treatment can be done as comfortably and efficiently as possible.

The technologically advanced, customisable unique look is transferred into the image of the treatment room.

And, of course, made of aluminium.

New Series 5: Undoubtedly the best choice!

*Because everything works.
Because we're always here.*

New Series 5

Welcome to the **New Series 5**: treatment units with suspended chair and vertical elevation. Open space under the chair, without obstacles, allowing total freedom of leg movement for dentists and their assistants.

Its ergonomic design means all the components are integrated and coordinated together, so that any dental work can be done as well, comfortably and efficiently as possible.

The perception of looking at such a technologically advanced, customisable and different treatment unit that it is almost unique, is transferred into the design and look of the consulting room. And, of course, made of aluminium.

New Series 5: Undoubtedly the best choice!



Sd-550 Touch Expert

Electronic treatment unit
(Whip arm system)

FEEL COMFORTABLE, WORK AT EASE

The principle behind the new Series 5 is comfort and ergonomics. Comfort and working ergonomics for doctor and assistant with total freedom for more natural movement and maximum flexibility in work positions.

The new Series 5 has been conceived to make your interventions simpler, more agile and effective. The suspended chair improves working accessibility to the patient, with an elevation range of between 380 and 800 mm for working sitting or standing.



Easy access to the instrument tray and auxiliary support from the work position.



Large capacity water unit with door for easy access.

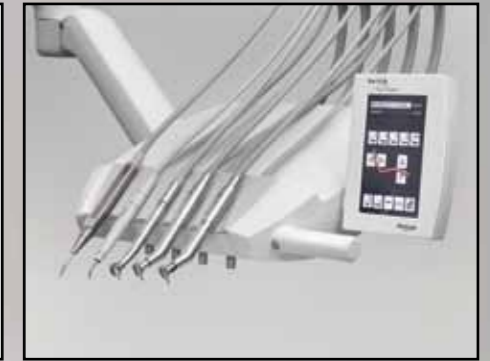

Instrument tray with touch screen and "Touch Expert" technology programmable for 4 users and optional self-locking tubing guides.



Sd-575 Touch Expert

Electronic treatment unit
(Hanging hose system)



Sd-575 Touch Expert

Electronic treatment unit
(Hanging hose system)

NEW VERSIONS, MAXIMUM PERFORMANCE

The Sd-575 features the hanging hose system offering the traditional style delivery unit with flexible positioning for different working styles.

Greater performance for top level treatments and intuitive, programmable handling of the instruments according to the specific conditions of each treatment.



Design the layout of the instruments as you wish, with 5 positions on the main tray and 3 on the auxiliary: modular, programmable and expandable.



Auxiliary support with two suction hoses installed as standard. Optional syringe 6F. stainless steel, polymerising lamp and intraoral camera.



ALUMINIUM CORE: Unit, chair and pedal manufactured in light anti-corrosive aluminium alloy. A full guarantee of durability.



Sd-580 Touch Expert

Electronic treatment unit
(Unit + cart)

MAXIMUM ADAPTABILITY, INFINITE POSSIBILITIES

Effectively the Sd-580 Touch Expert is the ideal solution for queries involving different professionals, or users used to working with the independent mobile cart system.

Its innovative and robust design and the total integration of the digital technology with its service makes this model an innovative, reliable unit that is highly versatile for any kind of clinic.



Wide elevation range from 380 to 800mm. for treatments standing or seated.



Proportional multifunction pedal with vertical activation and horizontal progression. Small base under the chair for better accessibility to the patient.



Mobile cart also made in light aluminium alloy with manual height adjustment and locking wheels



Touch Expert TECHNOLOGY

The treatment units of the New Series 5 from Ancar incorporate what we have called "Touching Technology". Our interpretation of how touch technology gives professionals new experiences and applications to make their work more precise, safer and more dynamic.

Touch technology is constantly taking over in any area of our society thanks to its great simplicity, ease and reliability.

The interaction, the dialogue between machine and user, its versatility and durability makes this technology ideal for maximum performance from your dental unit.

"Touching Technology" is Ancar's offer to give professionals greater performance, maximum precision and informative details verging on perfection.

With the New Series 5 "Touch Expert" from Ancar you will enjoy a new experience that is as practical, simple and intuitive as it is profitable.



SIMPLE, DYNAMIC AND CLEAR SCREEN: EASY AND INTUITIVE USE!

- "Check Control": electronic auto-check of the unit when starting up.
- The main screen gives the basic start information: user selection, name of the clinic, day, time, and the initial work functions: memories for chair, cup water, mouthwash water, unit lamp, auxiliary button and access to the setup screen.
- Countdown function.



PERSONALISE YOUR UNIT!

- Shows the name of the clinic, date and time.
- Programs and chooses 4 different users.
- Memorises the form of working of the instruments for each user.
- Choice of language for working.
- The values are automatically memorised without any need for additional confirmation.



CONFIGURE THE INSTRUMENTS ACCORDING TO EACH INTERVENTION!

- The touch technology allows you to precisely and intuitively configure each instrument.
- Programs the speed of the micro motor, the power and form of work of the ultrasound (perio, endo and scaler), and the intensity of the instrument light.
- The "secret button" keeps the configuration in the memory for each user.



ASSESS THE WORK RATE!

- Statistics of the use of the unit.
- Times cup filler used.
- Times bowl flush water used.
- Times position 0, 1, 2 and 3 memories used and return to mouthwash.
- Total and Partial statistics per user and general of the unit.
- Instrument work time: micromotor, turbine and ultrasound.
- Time of equipment in work phase.
- List of warnings that have appeared.
- Work hours of suction system.
- Lamp work hours.



GET THE BEST PERFORMANCE FROM YOUR MICROMOTOR!

- Optionally includes brush-free induction micro motor with ENDO and OPERATIVE functions.
- Programs the micro motor operation: type of counter-angle, RPM speed control, par / torque, turning direction, water / spray, light intensity...
- Selects the micro motor torque control between 10% and 100%.
- 20 modifiable programs for each user (10 in ENDO and 10 in OPERATIVE).
- MAX function: turns the progressive pedal into ON/OFF (works at maximum speed in any position).



CONFIGURE THE UNIT AS YOU WANT!

- Configure the 4 instruments on the main tray and adjust the details in each one.
- Configure the maximum cup filler and bowl flush-tray time.
- Adjust the maximum light voltage in the instruments.
- Modify the voltage /minimum speed of the micro motor.
- Activate/deactivate the automatic lighting of the micro motor light in Endo mode.
- Adjust the micro motor light delay.
- Choose instrument automatic forward or automatic reverse in Endo function.
- Program the delay according to automatic forward function.
- Adjust the acoustic warnings for micro motor reverse rotation, programming of Endo reverse, warnings and overloading.

Details that mark a difference.



ALUMINIUM CORE: Made in light, anticorrosive aluminium alloy.



State-of-the-art, highly robust technical and mechanical solutions.



Excellence in construction details.



Suction filter that is easy to access and clean.



Integrated USB port as standard.



Removable and autoclavable instrument support.



Porcelain spittoon bowl, manually revolving and built-in turning safety.



Removable, self-fixing spittoon bowl.



Removable cup filler for easier cleaning.



Proportional multifunction pedal with vertical activation and horizontal progression. Work functions with/without water, micro motor reverse, "chip-blower" and chair movements.



Water unit with door for easy access to suction and disinfection systems.



Auxiliary air, water and 230V sockets for peripheral instruments.

“The technology and performance of the new Series 5 make an innovative, reliable and highly versatile unit that gives me optimal and efficient results for every treatment”



Personalise the unit to suit you. Just the way you like it!



Wide range of intraoral cameras with integrated systems, idea for forming and motivating patients in all stages of the treatment. Clear images for immediate simple use.



17" 24 VDC. high resolution LCD display (1280 x 1024). Lasting, versatile, high output display with a wide range of integrated video options, designed specifically for dentistry environments. Anti-glare optical crystal, metal housing.



"Start" arm for LCD display with double rotating axis and vertical inclination. "Light" arm for LCD display with side and vertical rotation.



WEK water decontamination system for instrument hoses. Combined, automatic water circuit decontaminating cycles in rotating instruments. Non-toxic, continuous and effective decontaminating effect. Automatic supervision of sterilised dosing. Maintenance-free operation.



H1 system of continuous cleaning and complete disinfection of the suction system. Without need for additional manual disinfection. H1 includes the S1 automatic suction hose selection system.



Built-in amalgam recovery and air and water separation systems with selection valve: dry or wet suction.



Double auxiliary tray 410 x 310 mm. for hand instruments. Tray holder with silicon protection and removable for easier cleaning and disinfection.



Brush-free induction micro motor with ENDO functions. High performance at high and low speed (from 100 to 40,000 rpm), allowing a wide range of interventions:
- High speed for restoration operations.
- Low speed (from 100 to 4,000 rpm) for endodontics. Automatic reversal when the chosen torque is reached. Automatic anticlockwise return (adjustable timing). Sterilizable.
Lighter body, powerful and silent.

Practically maintenance-free. Long useful life. Non-vibrating.



EDI lamp with halogen light bulb at 25,000 Lux. With ON/OFF switch or optical sensor (optional).

MAIA lamp with LED technology. Light intensity adjustable from 3,000 to 35,000 Lux and constant temperature at 5,000 K.



ALYA lamp with LED technology at 50,000 Lux.

POLARIS lamp with LED technology with adjustable light intensity from 15,000 to 30,000 Lux.

The new generation of high-specification lamps with LED technology offer a whole range of benefits:

- LED lights generate a natural quality light which guarantees sharper vision in comparison with halogen light.
- LED light sources are longer lasting than halogen bulbs with lower energy consumption.
- A cold light. Minimum heat generated.
- LED technology offers greater field of vision and fewer shadows during treatment.
- Whiter light than the traditional bulb.



Anatomical cushion for very young children, with removable and washable cover.

Optional right-side arm turning through 180°.

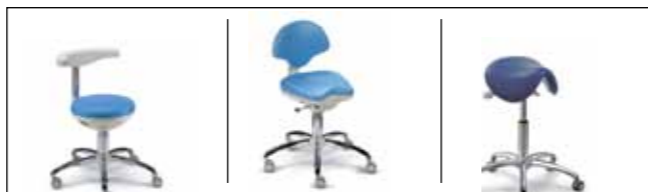

Td 170

Td 220

Td 300

Seat covering colours

"Standard"



Upholstered



"Soft Drive"



Technical Features

FUNCTIONS:

- Chair vertically suspended and raised to improve accessibility to the patient, with a lifting range from 380 to 800 mm. to work standing or seated.
- Connection box built into the water unit.
- Up to 8 instruments: 5 in the main tray and 3 in the auxiliary support.
- Multi-function proportional electronic pedal with selection of water, micro motor reversal, “chipblower” function and chair movements.
- Large auxiliary tray (310 x 410 mm.) for small hand instruments.
- Possibility of exchanging turbine and micro motor (MC3 and M40) in a single hose.
- Automatic lamp ON/OFF in reset and return to rinse.
- Individual adjustment of the water flow for each instrument.
- Auxiliary air, water and 220V sockets for peripheral instruments.
- USB 2.0 port built in as standard.
- Water and air supply ON/OFF built into the unit’s main switch.
- Programmable torch effect in selecting instruments with light.
- Syringe 6F. stainless steel installed as standard.

PROGRAMMING:

- Electronic unit controlled by microprocessor with “Touch Expert” display.
- “Autotest” of the unit at start-up.
- Identification of the dental centre, date and time.
- Programming for 4 different users and configuration of instruments for each one.
- Programming of ultrasound work parameters in ENDO, PERIO, SCALER, work range, and instrument light intensity.
- Adjustment of micro motor work parameters (with ENDO functions): torque control in Ncm, direct or reverse rotation, irrigation mode (spray / water), type of counter-angle and two types of speed: from 200 to 40,000 rpm and from 100 to 4,000 rpm.
- Graphic display of ultrasound power level and real turbine working speed.
- Statistics of the use of the unit: chair movements, instrument use, frequent warnings and recent warnings.
- System for detecting and controlling faults or warnings.
- Choice of language for working.
- Countdown function.
- Electronic adjustment of the cup water filling time and spittoon bowl flush with combined or individual setup.
- “Update Device” system: includes the latest programming updates even years after purchase.

ERGONOMICS:

- Electrically-operated chair with Trendelenburg and 5 position memories (three for working, reset and return to cuspidor).
- Diaphanous, obstacle-free space under the chair increasing work positions for dentist and assistant.
- Multi-position articulated head with minimum height of 380 mm., facilitating treatments in the upper pieces.
- Manually revolving spittoon bowl tray adaptable to the patient’s distance.
- Chair movements available on control pedal and keypad (principle and assistant).
- Arm and instrument tray with mechanical compensation and pneumatic brake: better handling with less effort.
- Optional right-side arm turning through 180°.

SAFETY FEATURES:

- In support of auxiliary cannula, back and lower part of the chair.
- In the chair upholstery when getting off.
- Of movements by main and auxiliary keyboard.
- On optional instruments (turbine, micromotor and ultrasound) through adjustor pedal.
- In choosing a second instrument.
- In turning the spittoon bowl .
- Unit conceived according to health product directive 93/42/CEE, design and construction meeting dental product standards: EN1640 / ISO7494, and safety, IEC standards.

HYGIENE:

- Removable and autoclavable silicone instrument mat.
- Standard suction hoses removable and thermo disinfected.
- Easy-clean suction filter.
- Removable spittoon bowl tray self-fixing at 135°.
- Removable cup filler for easier cleaning.
- Rotary instrument oil recuperator.
- Designed for easy cleaning and disinfection.
- “WEK” optional system for decontaminating water in instrument hoses.
- Optional “H1” system for disinfecting suction hoses.
- Amalgam separation for wet or dry section systems.

MATERIALS:

- ALUMINIUM CORE: Unit, chair and pedal manufactured in light anti-corrosive aluminium alloy.
- Porcelain cuspidor bowl.
- “Standard” and “Soft Drive” upholstery, high quality and hygienic, fireproof, steam and air permeable, highly elastic and pleasant feel.



THE PERFECT PRODUCT FOR A CLEANER PLANET

Ancar’s commitment is to create lasting products of high quality and impeccable performance to cause minimal environmental impact throughout the product life cycle. Quality, durability and efficiency are concepts that have been incorporated into our design, production and recycling processes.

Production processes maintain the priority of ensuring a balance between our activities and respect for the environment. In other words, a commitment to quality, environmental management and sustainable development principles.

Ancar’s Eco-arguments: a drive to offer efficient and sustainable dental equipment.

- We plan the whole manufacturing process in a sustainable way, starting with the acquisition and supply of economically and ecologically responsible parts and materials.
- We manage environmental and conservation aspects accordingly.
- We prevent pollution at its origin when and where possible.
- We promote environmental sustainability during the development of all processes: design, logistics, production, installation, maintenance and recycling.
- We ensure that our installations and products meet current environmental, conservation and process and unit recycling.
- We reduce the consumption of water, time and energy, both during the production process and the use of our units.
- We foster environmental respect by raising awareness, education, motivation and other initiatives by our team.

ANCAR ASSISTANCE



At Ancar we produce a precise, technical product and we know the importance of quality in our work. But we also know that a product’s qualities can fail if it is not supported by an adequate, efficient technical service. Because customer satisfaction lies in a quality service, our priority is to offer a top quality after-sales service.

We are proud of our professional team who ensures that the product arrives to the professional and as such, to the patient, in the best conditions. We are so sure of our quality that all Ancar equipment and stools come with a two-year guarantee. However, this conviction does not lessen our responsibility for any incident that may occur to our equipment from usage.

The sum of all these factors has led us to put a lot of our organisation’s energy into offering an effective, serious technical assistance service (Ancar Assistance) with great capacity to produce solutions. We therefore qualify our technicians, regularly keep them up-to-date with training, and only fit original spares, in order to leave your unit operative and in the best possible state, in the shortest possible time.

Enjoy speedy daily contact with our extensive network of distributors and official technical service. Go to our website, www.ancar-online.com and you will find the nearest official Ancar distributor for your query. If you prefer, contact us by e-mail at sat@ancar-online.com. We will be delighted to personally attend any queries, comment or suggestion you might like to make.

Dimensions

Sd-550 *Touch Expert*

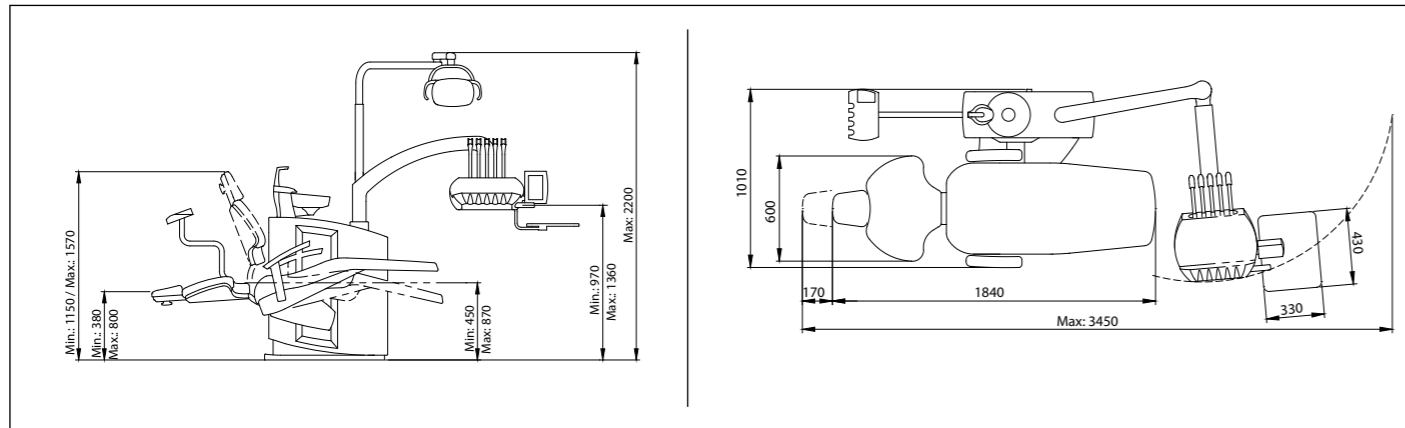

Sd-575 *Touch Expert*

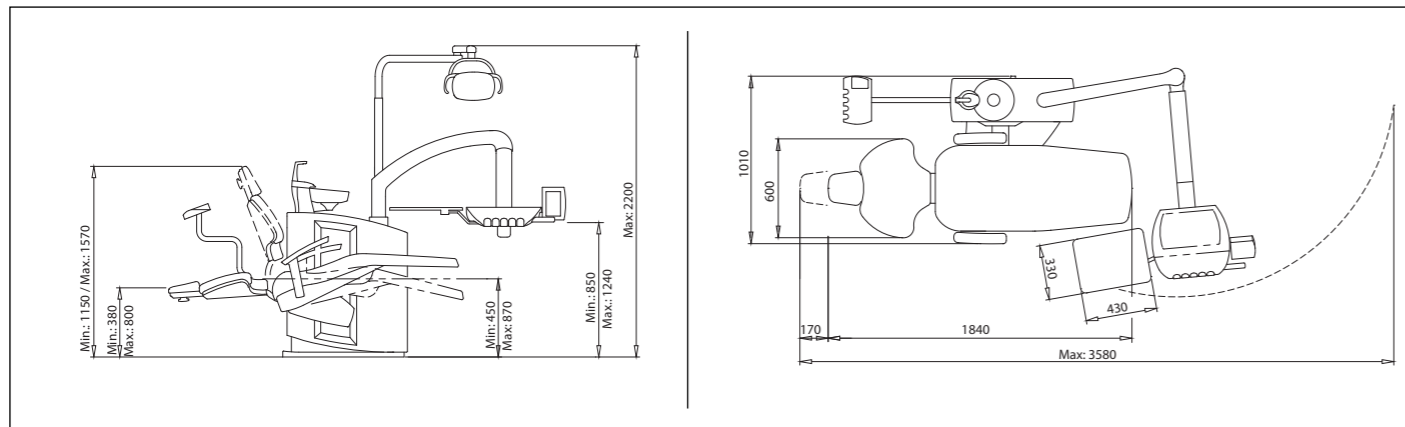

Sd-580 *Touch Expert*

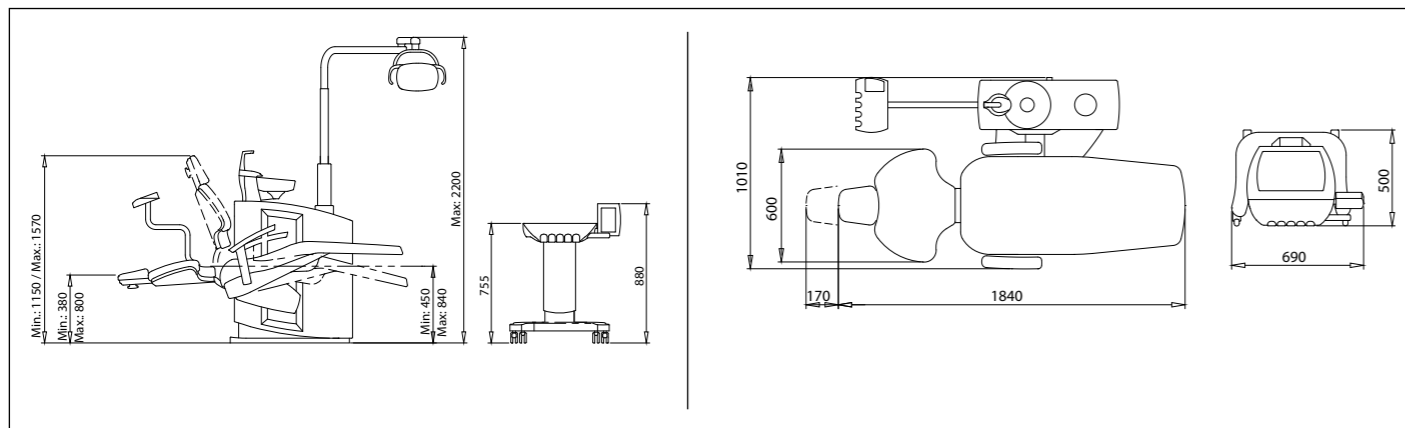

TECHNICAL DATA

• Voltage	220-240 V~
• Frequency	50 Hz
• Air pressure	5,5 Bar
• Water pressure	3 Bar
• Power	1.200 W
• Type of electric protection	I
• Type of operation	Intermittent
• Maximum load (patient)	160 kg
• Maximum instrument tray load	2 kg
• Electric micro motor instrument	24 V dc / 65 W
• MX micro motor instrument	24 V dc / 60 W (130 W peak)
• Bulb instrument light	3 V - 7 V / 2,5 W
• Ultrasound	24 V ac / 35 W
• Polymerising lamp	24 V ac / 150 W
• Syringe 6F	24 V ac / 150 W
• Operating lamp	17 V ac / 95 W

• Unit standard 93/42/EEC	Class IIa
• Insulation type	Tipo BF
• Net / gross weight of the unit	240 / 320 kg
• Type of dental unit	Electronic
• Installation type	Permanent
• Main fuse	T 6.3 A / 250 V
• Movement card fuse, line 24 V	T 32 mA / 250 V
• Transformer primary fuse, 9015092 PCB	TT 2.5 A / 250 V
• 1st line protection 24 V ac (amber / blue)	Polyswitch RUE400
• 2nd line protection 24 V ac (blue / brown)	Polyswitch RUE400+ RUE600
• Line protection 17 V ac (red / red)	Polyswitch RUE600+ RUE185
• Auxiliary outlets 24 V ac	4 x water unit 3 x instrument tray 1 x connections box
• Suction connection	500W / 230 V. Relays 20 A / 250 V
• Potential free AUX contact connections card	Max 250 V / 5 A
• Auxiliary output 230 V ac	50 W
• Main electro valves	24 V dc

INDEX

TREATMENT UNITS

Sd-550 <i>Touch Expert</i>	2
Sd-575 <i>Touch Expert</i>	6
Sd-580 <i>Touch Expert</i>	10
<i>Touch Expert</i> technology	12



OPTIONS AND TECHNICAL SPECIFICATIONS

Details that mark a difference	14
Options to personalise the unit	16
Seat covering colours	17
Technical Features	18
Green Processes for Sustainability	19
Ancar Assistance	19
Dimensions	20
Technical data	20

Ancar

DENTAL
INTELLIGENCE
with heart

Since 1958

Other units and dental carriages

Series 1



Sd-175



Sd-150



Sd-150 *Scandinavian*



Sd-60



Sd-60 *Scandinavian*



Cd-25

Series 3



Sd-350 *Touch Expert*



Sd-300 *Touch Expert*



Sd-300 *Touch Expert
Scandinavian*



Sd-80 *Touch Expert*



Sd-80 *Touch Expert
Scandinavian*



Cd-80 *Touch Expert*



CE
0434

QS4 LEA 015 V.2

Subject to design and/or specification changes
without prior warning. Made in Europe.

Antoni Carles, S.A.
Volta dels Garrofers, 41-42 Polígono Industrial "Els Garrofers"
08340 Vilassar de Mar (Barcelona-SPAIN)
Tel. (34) 93 754 07 97 Fax (34) 93 759 26 04
www.ancar-online.com / e-mail: ancar@ancar-online.com
To find your local dealer, please see our website www.ancar-online.com